

Pella® Lifestyle Series Wood Windows

Double-Hung Window (West Region) | PSE Simplified Package



Available at



Wood windows designed to deliver solutions for real life.



DOUBLE-HUNG WINDOW PACKAGE:

- ENERGY STAR® options available¹
- Dual pane design with Low-E insulating glass
- Low-maintenance EnduraClad® exterior finish in many color options
- Unfinished, primed, factory prefinished stained or painted interior
- Premium InView™ full fiberglass screen²
- Annealed glass
- 3-11/16" jamb depth with fold-out fins

\$955.00

up to and including 101 united inches (U.I.)

+ Add \$8.09 per U.I. for each U.I. over 101

Window width + window height = U.I. (always round up).

Example: A 35.25-in. + 72.5-in. window is equivalent to 108 U.I.

This is 7 U.I. over 101. \$955 + (7 x \$8.09) = \$1,011.61

ADDITIONAL BASE PRICE POINTS

United inches	≤ 60	≤ 70	≤ 80	≤ 90
Base price	\$623	\$704	\$785	\$866
U.I. factor			\$8.09	

FRAME TYPE

- 3-11/16-in. base wall depth with fold-out fins can be used in full frame replacement applications.
- The frame includes an exterior accessory groove.
- Frame sizes are available in 1/4-in. increments for a precise fit.
- Jamb extensions available in 1/8" increments up to 5-1/2-in. widths for 9-3/16-in. max wall depth.

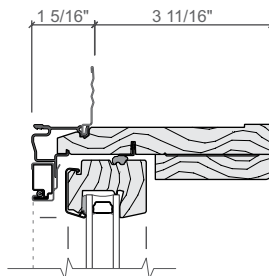

FRAME SIZE

	Minimum	Maximum
Width	21-in.	41.5-in.
Height	35-in.	77-in.

¹ Some Pella products may not meet ENERGY STAR® guidelines in Canada. For more information, contact your local Pella sales representative or go to energystar.gc.ca.

² Warning: Screen will not stop child or pet from falling out of window or door. Keep child or pet away from open window or door.

Pella® Lifestyle Series Wood Double-Hung Window (West Region) | PSE Simplified Package

		Optional Upgrades in Grey	≤101 U.I.	>101 U.I.	Costs
JAMB EXTENSION	4-9/16-in. jamb extension		\$41	\$46	
BLACK JAMBLINER			\$24	\$24	
EXTERIOR FINISH	<input type="checkbox"/> Black	<input type="checkbox"/> Brown	-	-	-
	<input type="checkbox"/> White	<input type="checkbox"/> Fossil	-	-	-
	<input type="checkbox"/> Iron Ore	<input type="checkbox"/> Almond	<input type="checkbox"/> Hartford Green		
	<input type="checkbox"/> Portobello	<input type="checkbox"/> Classic White	<input type="checkbox"/> Wolf Gray	\$45	\$45
	<input type="checkbox"/> Putty	<input type="checkbox"/> Brick Red			
INTERIOR FINISH	Factory prefinished painted interior	<input type="checkbox"/> Unfinished	<input type="checkbox"/> Linen White	-	-
		<input type="checkbox"/> Primed	<input type="checkbox"/> Bright White	-	-
		<input type="checkbox"/> Prefinished White			
	Factory prefinished stained interior	<input type="checkbox"/> Golden Oak	<input type="checkbox"/> Provincial	\$152	\$152
		<input type="checkbox"/> Early American	<input type="checkbox"/> Black		
GLASS	Low-E insulating dual-pane glass		-	-	-
	High altitude glass (where applicable)		\$22	\$22	
	Tempered glass		\$197	\$222	
GRILLES	7/8" simulated-divided light grilles		\$441	\$882	
	3/4" contour Traditional grilles-between-the-glass		\$143	\$285	
HARDWARE	<input type="checkbox"/> Champagne	<input type="checkbox"/> Brown	-	-	-
	<input type="checkbox"/> White	<input type="checkbox"/> Matte Black	-	-	-
	<input type="checkbox"/> Satin Nickel	<input type="checkbox"/> Satin Brass*	\$276	\$276	
SECURITY	Integrated Security Sensor		\$126	\$126	

* Available Early 2022.

Options Total + Base Price + Installation Price = Grand Total