

# Pella® Lifestyle Series Wood Windows

Double-Hung Window (East Region) | PSE Simplified Package



Available at



Wood windows designed to deliver solutions for real life.



## DOUBLE-HUNG WINDOW PACKAGE:

- ENERGY STAR® options available<sup>1</sup>
- Dual pane design with Low-E insulating glass
- Low-maintenance EnduraClad® exterior finish in many color options
- Unfinished, primed, factory prefinished stained or painted interior
- Premium InView™ full fiberglass screen<sup>2</sup>
- Annealed glass
- 3-11/16" jamb depth with fold-out fins

## \$839.00

up to and including 101 united inches (U.I.)

**+ Add \$7.11 per U.I. for each U.I. over 101**

Window width + window height = U.I. (always round up).

Example: A 35.25-in. + 72.5-in. window is equivalent to 108 U.I.

This is 7 U.I. over 101.  $\$839 + (7 \times \$7.11) = \$888.76$

## ADDITIONAL BASE PRICE POINTS

United inches	≤ 60	≤ 70	≤ 80	≤ 90
Base price	\$548	\$619	\$690	\$761
U.I. factor			\$7.11	

## FRAME TYPE

- 3-11/16-in. base wall depth with fold-out fins can be used in full frame replacement applications.
- The frame includes an exterior accessory groove.
- Frame sizes are available in 1/4-in. increments for a precise fit.
- Jamb extensions available in 1/8" increments up to 5-1/2-in. widths for 9-3/16-in. max wall depth.

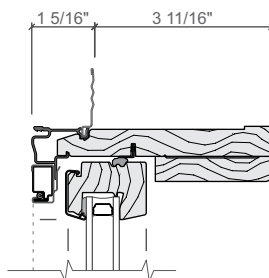

## FRAME SIZE

	Minimum	Maximum
Width	21-in.	41.5-in.
Height	35-in.	77-in.

<sup>1</sup> Some Pella products may not meet ENERGY STAR® guidelines in Canada. For more information, contact your local Pella sales representative or go to [energystar.gc.ca](http://energystar.gc.ca).

<sup>2</sup> Warning: Screen will not stop child or pet from falling out of window or door. Keep child or pet away from open window or door.

Pella® Lifestyle Series Wood Double-Hung Window (East Region) | PSE Simplified Package

		Optional Upgrades in Grey	≤101 U.I.	>101 U.I.	Costs
<b>JAMB EXTENSION</b>	4-9/16-in. jamb extension		\$36	\$41	
<b>BLACK JAMBLINER</b>			\$22	\$22	
<b>EXTERIOR FINISH</b>	<input type="checkbox"/> Black	<input type="checkbox"/> Brown	-	-	-
	<input type="checkbox"/> White	<input type="checkbox"/> Fossil			
	<input type="checkbox"/> Iron Ore	<input type="checkbox"/> Almond	<input type="checkbox"/> Hartford Green		
	<input type="checkbox"/> Portobello	<input type="checkbox"/> Classic White	<input type="checkbox"/> Wolf Gray	\$39	\$39
	<input type="checkbox"/> Putty	<input type="checkbox"/> Brick Red			
<b>INTERIOR FINISH</b>	Factory prefinished painted interior	<input type="checkbox"/> Unfinished <input type="checkbox"/> Primed <input type="checkbox"/> Prefinished White	<input type="checkbox"/> Linen White <input type="checkbox"/> Bright White	-	-
	Factory prefinished stained interior	<input type="checkbox"/> Golden Oak <input type="checkbox"/> Early American	<input type="checkbox"/> Provincial <input type="checkbox"/> Black	\$133	\$133
<b>GLASS</b>	Low-E insulating dual-pane glass		-	-	-
	High altitude glass (where applicable)		\$20	\$20	
	Tempered glass		\$173	\$196	
<b>GRILLES</b>	7/8" simulated-divided light grilles		\$388	\$776	
	3/4" contour Traditional grilles-between-the-glass		\$125	\$250	
<b>HARDWARE</b>	<input type="checkbox"/> Champagne	<input type="checkbox"/> Brown	-	-	-
	<input type="checkbox"/> White	<input type="checkbox"/> Matte Black			
	<input type="checkbox"/> Satin Nickel	<input type="checkbox"/> Satin Brass*	\$243	\$243	
<b>SECURITY</b>	Integrated Security Sensor		\$111	\$111	

\* Available Early 2022.

Options Total  + Base Price  + Installation Price  = Grand Total