

Pella® Lifestyle Series Wood Windows

Double-Hung Window (Hawaii/Alaska Region) | PSE Simplified Package



Available at



Wood windows designed to deliver solutions for real life.



DOUBLE-HUNG WINDOW PACKAGE:

- ENERGY STAR® options available¹
- Dual pane design with Low-E insulating glass
- Low-maintenance EnduraClad® exterior finish in many color options
- Unfinished, primed, factory prefinished stained or painted interior
- Premium InView™ full fiberglass screen²
- Annealed glass
- 3-11/16-in. jamb depth with fold-out fins

\$1,222.00

up to and including 101 united inches (U.I.)

+ Add \$10.35 per U.I. for each U.I. over 101

Window width + window height = U.I. (always round up).

Example: A 35.25-in. + 72.5-in. window is equivalent to 108 U.I.

This is 7 U.I. over 101. $\$1,222 + (7 \times \$10.35) = \$1,294.46$

ADDITIONAL BASE PRICE POINTS

United inches	≤ 60	≤ 70	≤ 80	≤ 90
Base price	\$798	\$901	\$1,005	\$1,108
U.I. factor	\$10.35			

FRAME TYPE

- 3-11/16-in. base wall depth with fold-out fins can be used in full frame replacement applications.
- The frame includes an exterior accessory groove.
- Frame sizes are available in 1/4-in. increments for a precise fit.
- Jamb extensions available in 1/8-in. increments up to 5-1/2-in. widths for 9-3/16-in. max wall depth.

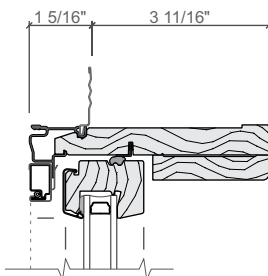

FRAME SIZE

	Minimum	Maximum
Width	21-in.	41.5-in.
Height	35-in.	77-in.

¹ Some Pella products may not meet ENERGY STAR® guidelines in Canada. For more information, contact your local Pella sales representative or go to energystar.gc.ca.

² Warning: Screen will not stop child or pet from falling out of window or door. Keep child or pet away from open window or door.

Pella® Lifestyle Series Wood Windows

Double-Hung Window (Hawaii/Alaska Region) | PSE Simplified Package

		Optional Upgrades in Grey	≤101 U.I.	>101 U.I.	Costs
JAMB EXTENSION	4-9/16-in. jamb extension		\$52	\$59	
BLACK JAMBLINER			\$31	\$31	
EXTERIOR FINISH	<input type="checkbox"/> Black	<input type="checkbox"/> Brown	-	-	-
	<input type="checkbox"/> White	<input type="checkbox"/> Fossil	-	-	-
	<input type="checkbox"/> Iron Ore	<input type="checkbox"/> Almond	<input type="checkbox"/> Hartford Green		
	<input type="checkbox"/> Portobello	<input type="checkbox"/> Classic White	<input type="checkbox"/> Wolf Gray	\$57	\$57
	<input type="checkbox"/> Putty	<input type="checkbox"/> Brick Red			
INTERIOR FINISH	Factory prefinished painted interior	<input type="checkbox"/> Unfinished <input type="checkbox"/> Primed <input type="checkbox"/> Prefinished White	<input type="checkbox"/> Linen White <input type="checkbox"/> Bright White	-	-
	Factory prefinished stained interior	<input type="checkbox"/> Golden Oak <input type="checkbox"/> Early American	<input type="checkbox"/> Provincial <input type="checkbox"/> Black	\$194	\$194
GLASS	Low-E insulating dual-pane glass		-	-	-
	High altitude glass (where applicable)		\$29	\$29	
	Tempered glass		\$252	\$285	
GRILLES	7/8" simulated-divided light grilles		\$565	\$1,129	
	3/4" contour Traditional grilles-between-the-glass		\$182	\$364	
HARDWARE	<input type="checkbox"/> Champagne	<input type="checkbox"/> Brown	-	-	-
	<input type="checkbox"/> White	<input type="checkbox"/> Matte Black	-	-	-
	<input type="checkbox"/> Satin Nickel	<input type="checkbox"/> Satin Brass*	\$354	\$354	
SECURITY	Integrated Security Sensor		\$161	\$161	

* Available Early 2022.

Options Total + Base Price + Installation Price = Grand Total