

Pella® Lifestyle Series Wood Windows

Casement Window (Hawaii/Alaska Region) | PSE Simplified Package



Available at



#1 performing wood window for the combination of energy, sound and value.¹



CASEMENT WINDOW PACKAGE:

- ENERGY STAR® options available²
- High-altitude glazing (where applicable)
- Low-E insulating glass
- Low-maintenance Enduraclad® exterior finish with many color options
- 3-11/16-in. jamb depth with fold-out fins
- Premium InView™ full fiberglass screen³

\$1,355.00

up to and including 101 united inches (U.I.)

+ Add \$11.09 per U.I. for each U.I. over 101

Window width + window height = U.I. (always round up).

Example: A 35.25-in. + 72.5-in. window is equivalent to 108 U.I.

This is 7 U.I. over 101. \$1,355 + (7 x \$11.09) = \$1,432.65

ADDITIONAL BASE PRICE POINTS

United inches	≤ 60	≤ 70	≤ 80	≤ 90
Base price	\$900	\$1,011	\$1,122	\$1,233
U.I. factor	\$11.09			

Triple-pane with integrated blind upgrades shown

FRAME TYPE

- 3-11/16-in. base wall depth with fold-out fins can be used in full frame replacement applications.
- The frame includes an exterior accessory groove.
- Frame sizes are available in 1/4-in. increments for a precise fit.
- Jamb extensions available in 1/8-in. increments up to 5-1/2-in. widths for 9-3/16-in. max wall depth.

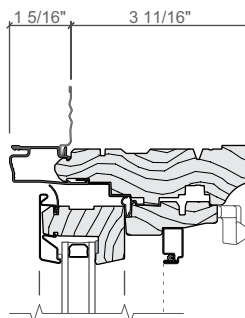

FRAME SIZE

	Minimum	Maximum
Width	17-in.	35-in.
Height	17-in.	73-in.

¹ Performance solutions require upgrade to triple-pane, AdvancedComfort Low-E and mixed glazing thickness glass. Based on comparing product quotes and published STC/OITC and U-Factor ratings of leading national wood window and patio door brands.

² Some Pella products may not meet ENERGY STAR® guidelines in Canada. For more information, contact your local Pella sales representative or go to energystar.gc.ca.

³ Warning: Screen will not stop child or pet from falling out of window or door. Keep child or pet away from open window or door.

Pella® Lifestyle Series Wood Windows

Casement Window (Hawaii/Alaska Region) | PSE Simplified Package

	Optional Upgrades in Grey	≤101 U.I.	>101 U.I.	Costs
JAMB EXTENSION	4-9/16-in. jamb extension	\$53	\$57	
PERFORMANCE PACKAGES	Energy Efficiency package (Triple-pane, AdvancedComfort glass)	\$507	\$542	
	Ultimate Performance package (Triple-pane, 5mm/3mm/4mm, AdvancedComfort glass)	\$575	\$615	
EXTERIOR FINISH	<input type="checkbox"/> Black	<input type="checkbox"/> Brown	-	-
	<input type="checkbox"/> White	<input type="checkbox"/> Fossil	-	-
	<input type="checkbox"/> Iron Ore	<input type="checkbox"/> Almond	<input type="checkbox"/> Hartford Green	
	<input type="checkbox"/> Portobello	<input type="checkbox"/> Classic White	<input type="checkbox"/> Wolf Gray	\$58
	<input type="checkbox"/> Putty	<input type="checkbox"/> Brick Red		\$58
INTERIOR FINISH	Factory prefinished painted interior	<input type="checkbox"/> Unfinished	<input type="checkbox"/> Linen White	-
		<input type="checkbox"/> Primed	<input type="checkbox"/> Bright White	-
		<input type="checkbox"/> Prefinished White		-
	Factory prefinished stained interior	<input type="checkbox"/> Golden Oak	<input type="checkbox"/> Provincial	\$198
		<input type="checkbox"/> Early American	<input type="checkbox"/> Black	\$198
GLASS	Low-E insulating dual-pane glass	-	-	-
	High altitude glass (where applicable)	\$29	\$29	
	Tempered glass	\$257	\$275	
GRILLES	7/8" simulated-divided light grilles	\$576	\$864	
	3/4" contour Traditional grilles-between-the-glass	\$186	\$279	
HARDWARE	<input type="checkbox"/> Champagne	<input type="checkbox"/> Brown	-	-
	<input type="checkbox"/> White	<input type="checkbox"/> Matte Black	-	-
	<input type="checkbox"/> Satin Nickel	<input type="checkbox"/> Satin Brass*	\$181	\$181
INTEGRATED BLINDS OR SHADES (Triple-pane only)	Integrated blinds	<input type="checkbox"/> White	<input type="checkbox"/> Mocha	
		<input type="checkbox"/> Poplar White	<input type="checkbox"/> Storm	\$432
		<input type="checkbox"/> Bisque	<input type="checkbox"/> Black	\$432
		<input type="checkbox"/> Golden		\$432
	Integrated shades	Light-Filtering:	Room-Darkening:	
	<input type="checkbox"/> White	<input type="checkbox"/> Cotton	\$538	
	<input type="checkbox"/> Maize	<input type="checkbox"/> Bamboo	\$538	
	<input type="checkbox"/> Silver	<input type="checkbox"/> Ash	\$538	
SCREEN	Rolscreen	\$363	\$388	
SECURITY	Integrated Security Sensor	\$164	\$164	

* Available Early 2022.

Options Total + Base Price + Installation Price = Grand Total