

# Pella® Lifestyle Series Wood Windows

Casement Window (East Region) | PSE Simplified Package



Available at



#1 performing wood window for the combination of energy, sound and value.<sup>1</sup>



## CASEMENT WINDOW PACKAGE:

- ENERGY STAR® options available<sup>2</sup>
- High-altitude glazing (where applicable)
- Low-E insulating glass
- Low-maintenance Enduraclad® exterior finish with many color options
- 3-11/16" jamb depth with fold-out fins
- Premium InView™ full fiberglass screen<sup>3</sup>

# \$1,111.00

up to and including 101 united inches (U.I.)

**+ Add \$8.98 per U.I. for each U.I. over 101**

Window width + window height = U.I. (always round up).  
 Example: A 35.25-in. + 72.5-in. window is equivalent to 108 U.I. This is 7 U.I. over 101. \$1,111 + (7 x \$8.98) = \$1,173.86

## ADDITIONAL BASE PRICE POINTS

United inches	≤ 60	≤ 70	≤ 80	≤ 90
Base price	\$743	\$833	\$923	\$1,013
U.I. factor	\$8.98			

Triple-pane with integrated blind upgrades shown

## FRAME TYPE

- 3-11/16-in. base wall depth with fold-out fins can be used in full frame replacement applications.
- The frame includes an exterior accessory groove.
- Frame sizes are available in 1/4-in. increments for a precise fit.
- Jamb extensions available in 1/8-in. increments up to 5-1/2-in. widths for 9-3/16-in. max wall depth.

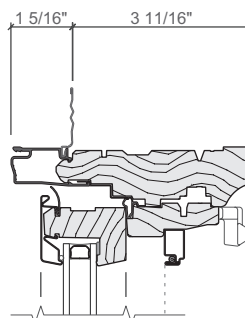

## FRAME SIZE

	Minimum	Maximum
Width	17-in.	35-in.
Height	17-in.	73-in.

<sup>1</sup> Performance solutions require upgrade to triple-pane, AdvancedComfort Low-E and mixed glazing thickness glass. Based on comparing product quotes and published STC/OITC and U-Factor ratings of leading national wood window and patio door brands.

<sup>2</sup> Some Pella products may not meet ENERGY STAR® guidelines in Canada. For more information, contact your local Pella sales representative or go to [energystar.gc.ca](http://energystar.gc.ca).

<sup>3</sup> Warning: Screen will not stop child or pet from falling out of window or door. Keep child or pet away from open window or door.

Pella® Lifestyle Series Wood Casement Window (East Region) | PSE Simplified Package

	Optional Upgrades in Grey	≤101 U.I.	>101 U.I.	Costs
<b>JAMB EXTENSION</b>	4-9/16-in. jamb extension	\$43	\$46	
<b>PERFORMANCE PACKAGES</b>	Energy Efficiency package (Triple-pane, AdvancedComfort glass)	\$555	\$591	
	Ultimate Performance package (Triple-pane, 5mm/3mm/4mm, AdvancedComfort glass)	\$616	\$656	
<b>EXTERIOR FINISH</b>	<input type="checkbox"/> Black	<input type="checkbox"/> Brown	-	-
	<input type="checkbox"/> White	<input type="checkbox"/> Fossil	-	-
	<input type="checkbox"/> Iron Ore	<input type="checkbox"/> Almond	<input type="checkbox"/> Hartford Green	
	<input type="checkbox"/> Portobello	<input type="checkbox"/> Classic White	<input type="checkbox"/> Wolf Gray	\$47
	<input type="checkbox"/> Putty	<input type="checkbox"/> Brick Red		\$47
<b>INTERIOR FINISH</b>	Factory prefinished painted interior	<input type="checkbox"/> Unfinished <input type="checkbox"/> Primed <input type="checkbox"/> Prefinished White	<input type="checkbox"/> Linen White <input type="checkbox"/> Bright White	-
	Factory prefinished stained interior	<input type="checkbox"/> Golden Oak <input type="checkbox"/> Early American	<input type="checkbox"/> Provincial <input type="checkbox"/> Black	\$192
				\$192
<b>GLASS</b>	Low-E insulating dual-pane glass			-
	High altitude glass (where applicable)			\$24
	Tempered glass			\$208
<b>GRILLES</b>	7/8" simulated-divided light grilles			\$466
	3/4" contour Traditional grilles-between-the-glass			\$151
<b>HARDWARE</b>	<input type="checkbox"/> Champagne	<input type="checkbox"/> Brown		-
	<input type="checkbox"/> White	<input type="checkbox"/> Matte Black		-
	<input type="checkbox"/> Satin Nickel	<input type="checkbox"/> Satin Brass		\$146
<b>INTEGRATED BLINDS OR SHADES</b> (Triple-pane only)	Integrated blinds	<input type="checkbox"/> White <input type="checkbox"/> Poplar White <input type="checkbox"/> Bisque <input type="checkbox"/> Golden	<input type="checkbox"/> Mocha <input type="checkbox"/> Storm <input type="checkbox"/> Black	\$382
	Integrated shades	Light-Filtering: <input type="checkbox"/> White <input type="checkbox"/> Maize <input type="checkbox"/> Silver	Room-Darkening: <input type="checkbox"/> Cotton <input type="checkbox"/> Bamboo <input type="checkbox"/> Ash	\$476
<b>SCREEN</b>	Rolscreen			\$294
<b>SECURITY</b>	Integrated Security Sensor			\$133

Options Total  + Base Price  + Installation Price  = Grand Total